

**Plan**

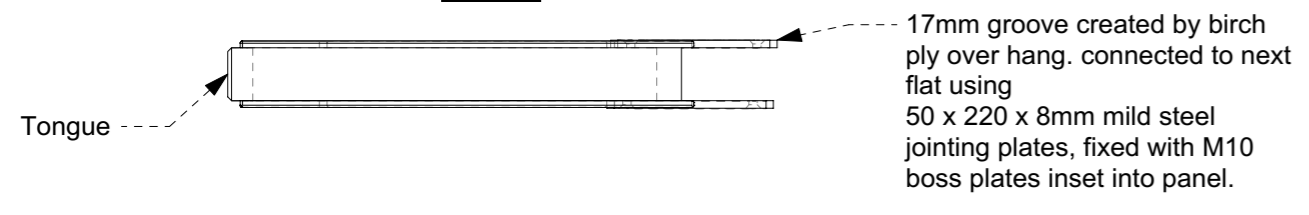

17mm groove created by birch ply over hang, connected to next flat using 50 x 220 x 8mm mild steel jointing plates, fixed with M10 boss plates inset into panel.

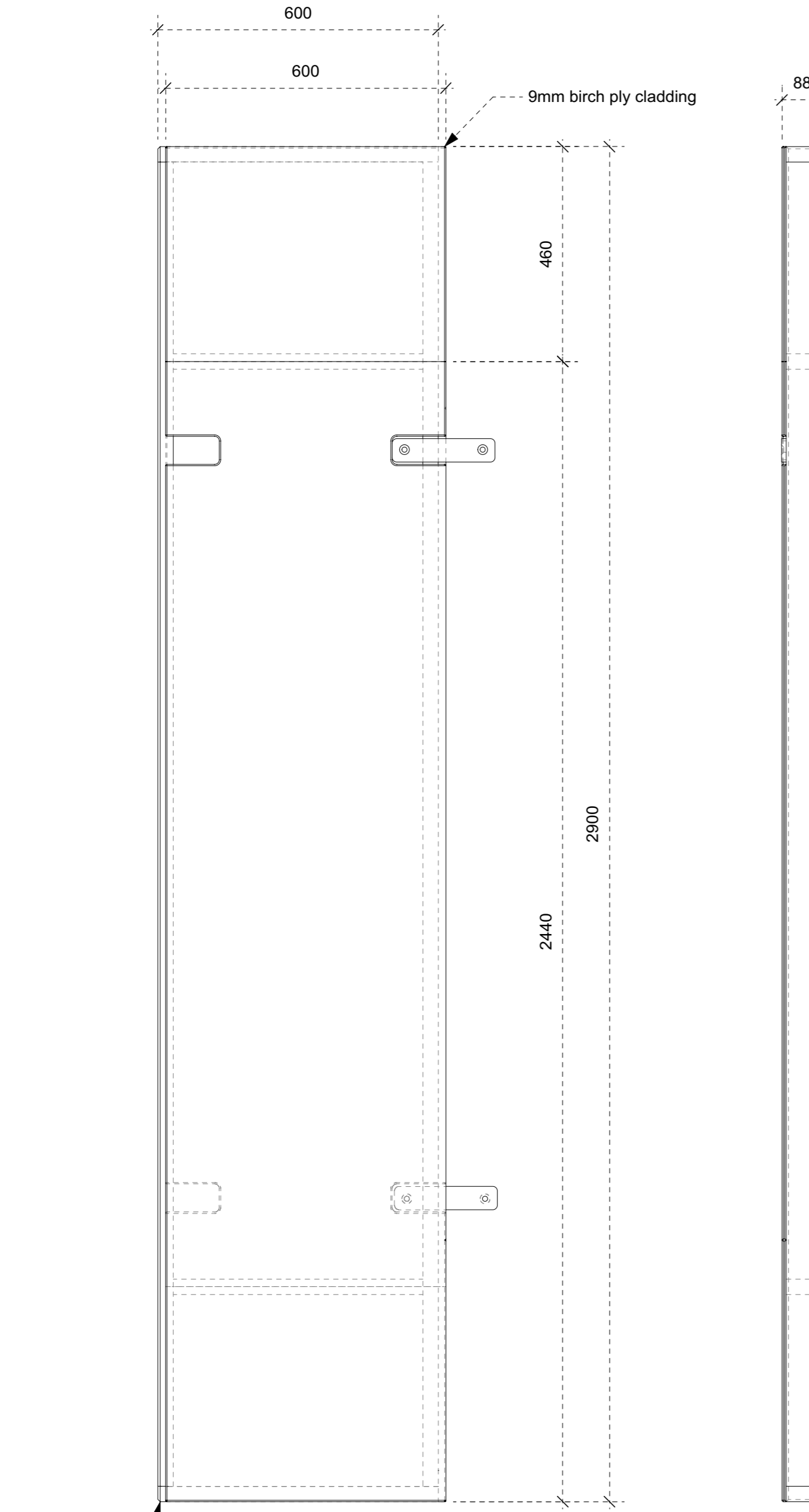

**Front Elevation**

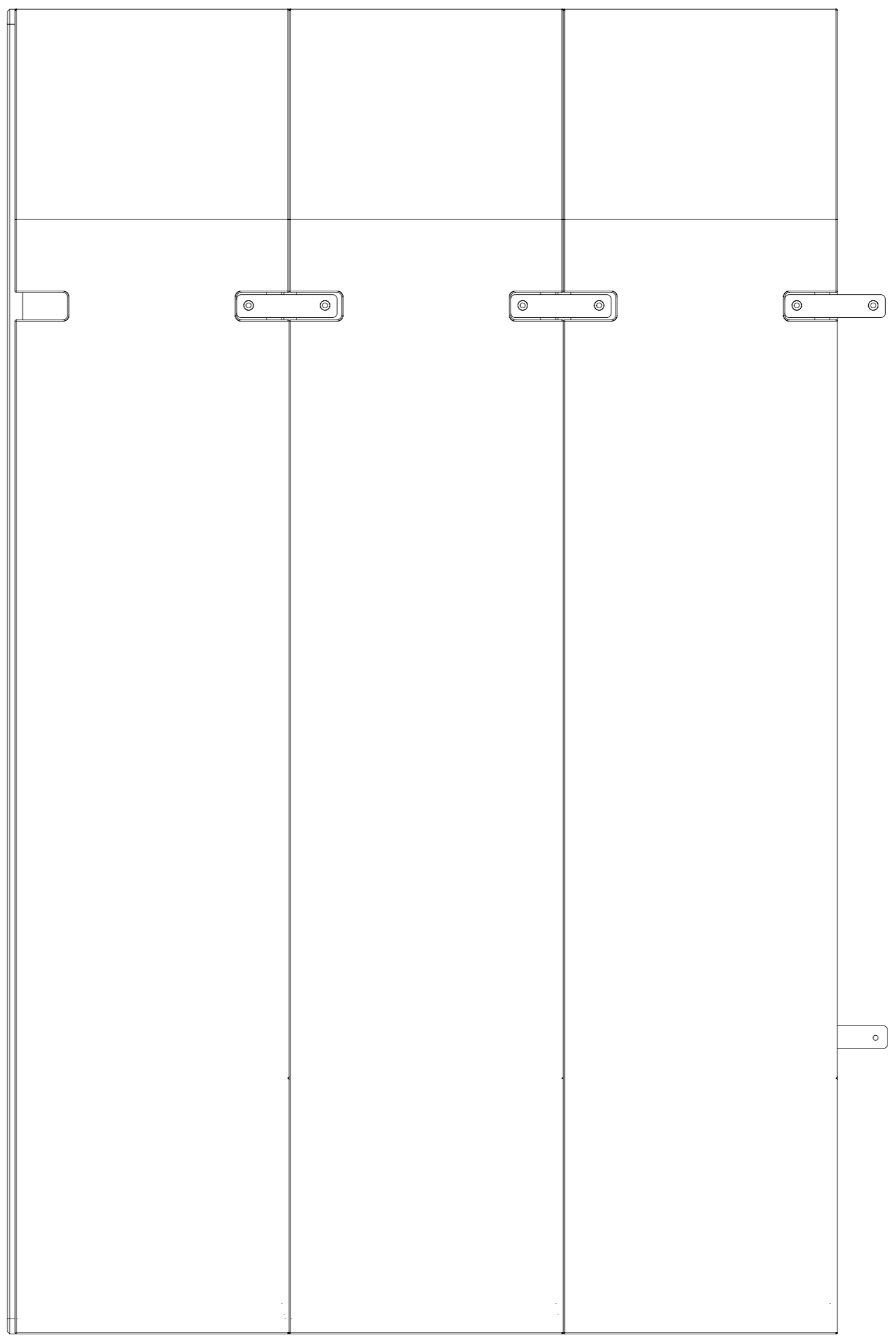
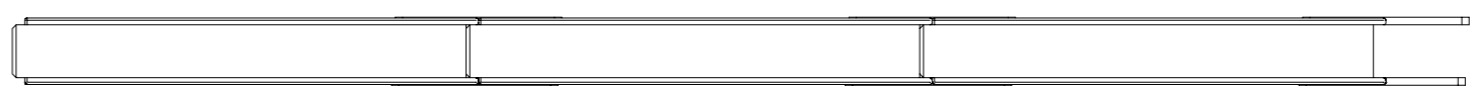

**Right Elevation**

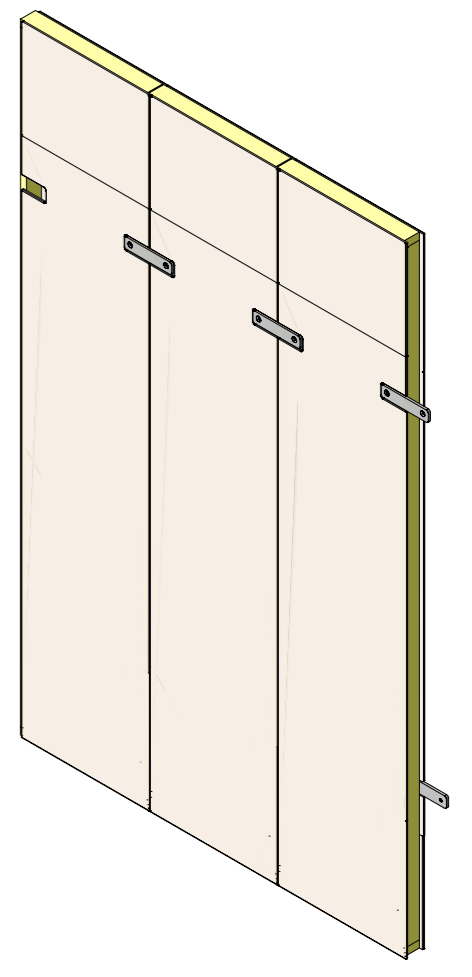

Frame offset from cladding by 17mm to create tongue

Client: GB Festivals Ltd.	Venue: Adam House, Edinburgh	Designer: Simon Cook	Date: 31/5/19	Scale: 1:10 @A2
<p><small>Please Note: This NO LIABILITY is accepted for any action resulting from this drawing, however caused. Drawings show intent only. Clients are urged to check the drawing thoroughly, and if necessary, seek the advice of a qualified structural engineer. It is the engineers responsibility to ensure that all proposals are sound, to correct any errors and advise of any changes as recommended by themselves.</small></p>				
Tel: 07966 182586		Email: scook@protonmail.com		

Drawing No.	1
of	1